

## **140 LITRE KOMPAKT CONTAINER: SIMPLY A BETTER BIN**



**EASY HANDLING  
VERSATILE  
STABLE DESIGN**

### **Designed for local market**

- Manufactured in accordance with AS4123
- Stable on uneven surfaces and against wind
- Larger footprint increases stability
- Lower centre of gravity



### **Multiple applications**

- Part of a multi-bin system
- Assists with waste reduction goals but with the look of a larger container
- Ideal for homes, multi-unit dwellings and offices



### **Improved design features**

- Larger opening and body
- Non-impact lid that reduces noise
- Internal concave floor assists emptying



# 140 LITRE CONTAINER

## Material

- **Polymer components:**
  - Injection moulded from specially designed HDPE
  - Resistant to decay, frost, heat and chemicals
  - Special UV-stabilisation provides excellent ageing characteristics
- **Corrosion resistant steel axle**
- **Noise reduction:**
  - Quiet-running solid rubber tyres
  - Tight-fitting axle
- **Long service life:**
  - High quality materials
  - Most advanced manufacturing processes
  - Withstands exposure to high mechanical stress levels
- **Recycling:**
  - All container parts are recyclable

## Advantages

- Easy to manoeuvre
- Versatile, with a comprehensive accessories range
- Complies with EN840 and AS4123 quality requirements
- Particularly stable due to external position of wheels
- Safe and easy to handle
- Suitable for all DIN lifting equipment
- Double angle rail for greater safety when emptying
- Compatible with identification and weighing systems
- Special ribs prevent containers from becoming jammed when stacked

## Imprints and markings

- Manufacturer, year of manufacture, material
- Nominal volume, max permitted total weight
- EN 840 and AS4123 markings
- Individual markings with imprints, hot-foil printing or adhesive labels\*
- Customer specific serial numbers if required\*

## Accessories

- For accessories and special design variations such as lid apertures and locks please refer to the separate accessories sheet for 2-wheeled containers

## Quality

- Certified according to EN840
- Manufactured in accordance with AS4123

## Dimensions - Weights - Standards

- Nominal volume: 140 litres
- Net weight: approx 10.4 kg
- Max load: 56 kg
- Permitted total weight: 70 kg

- |     |        |     |        |     |        |
|-----|--------|-----|--------|-----|--------|
| ■ A | 915 mm | ■ D | 615 mm | ■ G | 505 mm |
| ■ B | 870 mm | ■ E | 535 mm |     |        |
| ■ C | 550 mm | ■ F | 395 mm |     |        |

Measurements to be used as a guide only – variations will occur

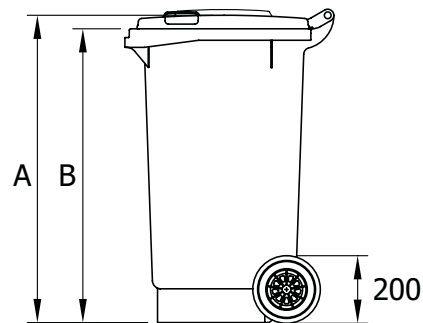
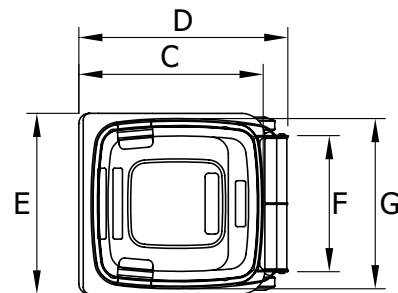

## Colours

- Standard colours: black, nature green, dark green, grey
- Special colours are available on request\* – common colours include blue, yellow, red, orange

